



# Hindustan Urvarak & Rasayan Limited

(A Joint Venture of NTPC, CIL, IOCL, FCIL & HFCL)

Ref No.: HURL/Sindri/C&M/22-23/1707/CORG-1

Date: 15-11-2022

## CORRIGENDUM – 1

With reference to tender No.- HURL/Sindri/C&M/22-23/1707 Dated 10/11/2022 (Tender id: 2022\_HURL\_722788\_1) for the work of “Supply and Installation of Muti-Tier Heavy Duty Shelving System at HURL Sindri”, Corrigendum-1 is hereby issued as per enclosed details.

### Part/Sec. of Tender Document: Page no.-90 , SECTION – V : SCOPE OF WORK, TECHNICAL SPECIFICATIONS AND OTHER TERMS & CONDITIONS

Existing Clause	As per drawing on Page-90 of Tender Document
Amended Clause	As per drawing enclosed with Corrigendum-1 (Bidders shall quote their bid as per the drawing enclosed with Corrigendum-1 only.)

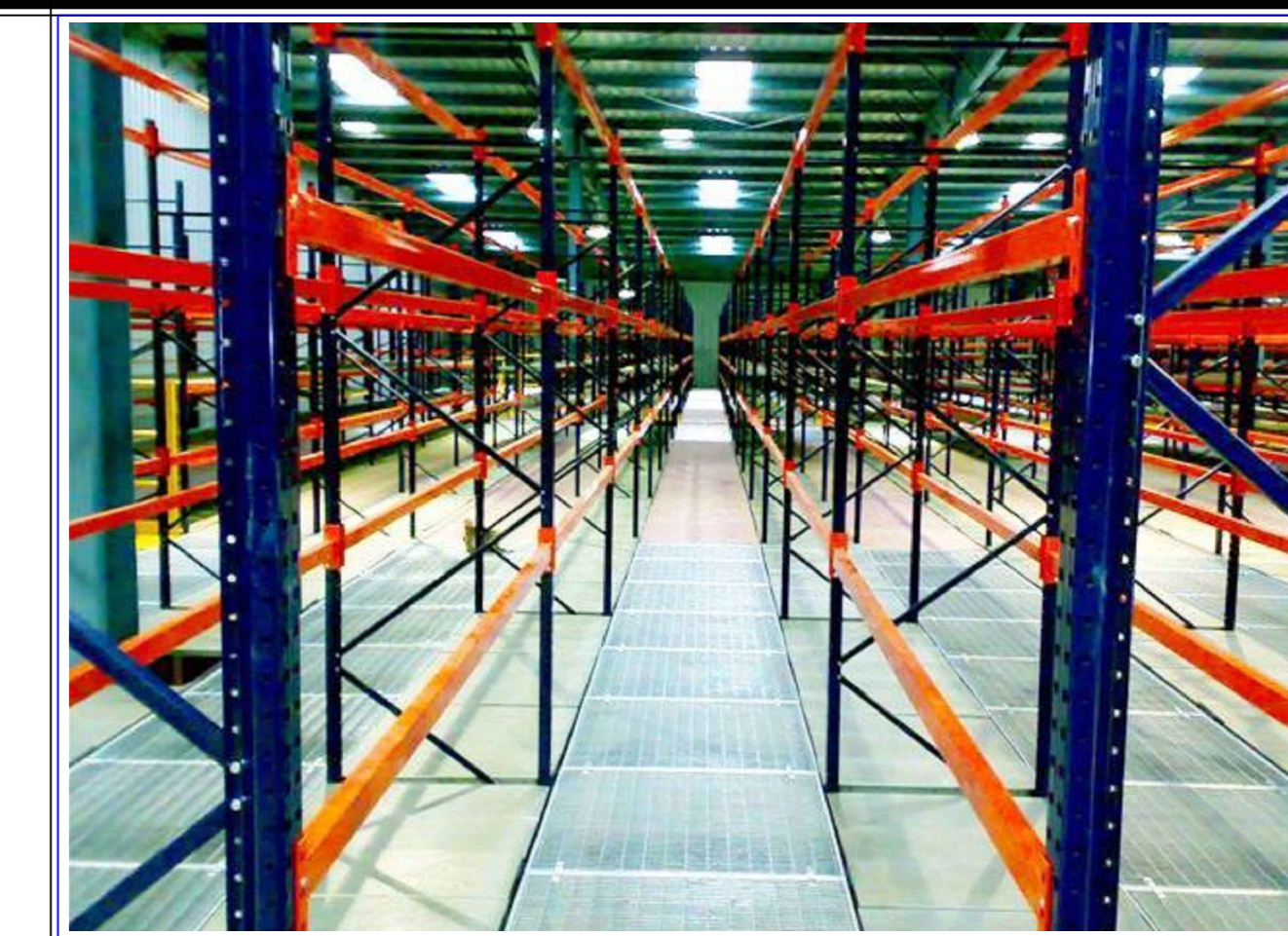
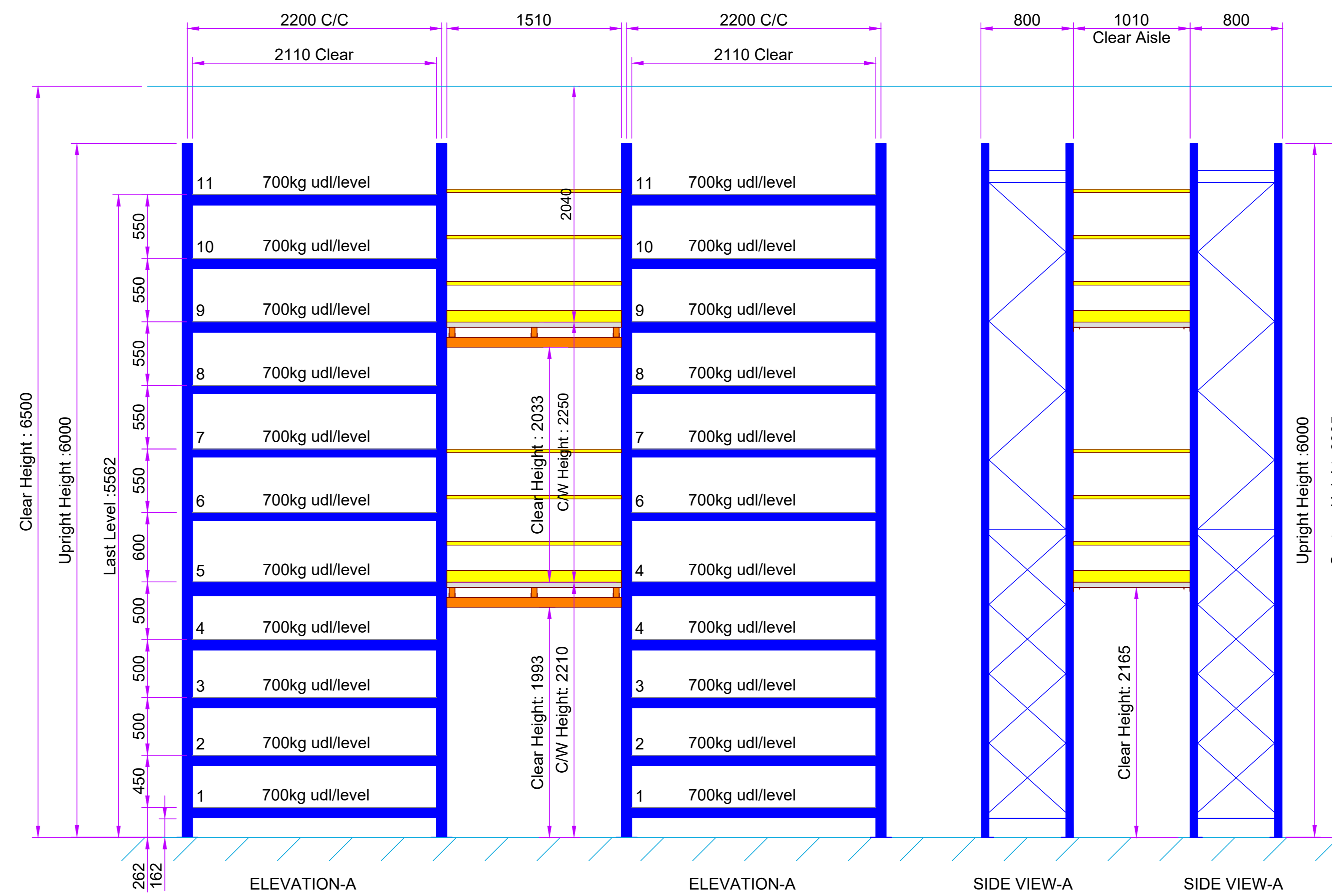

TYPICAL HEAVY DUTY SHELVING

ACCESSORIES

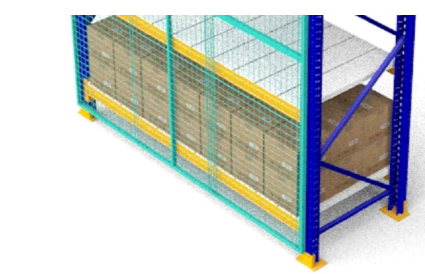

Mesh Cladding(Tube)  
Grid Size (50x50)  
Extremes sides of racks  
(Shown in "#")

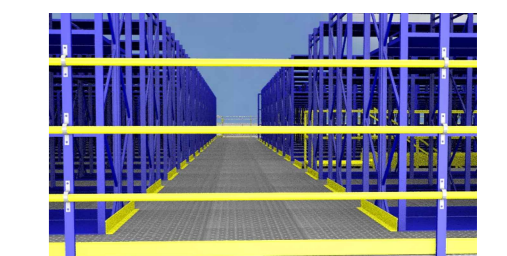

Railing & Kick Plate  
Periphery of the system

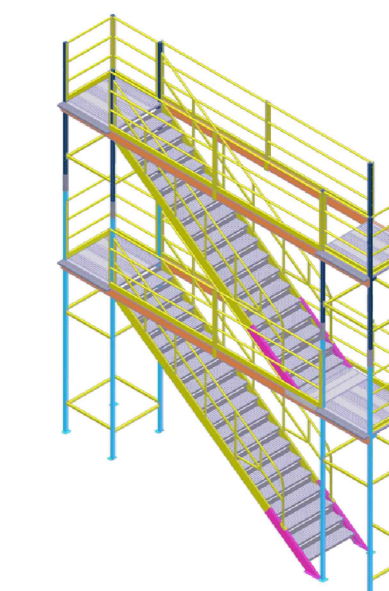

Staircase (G+2)

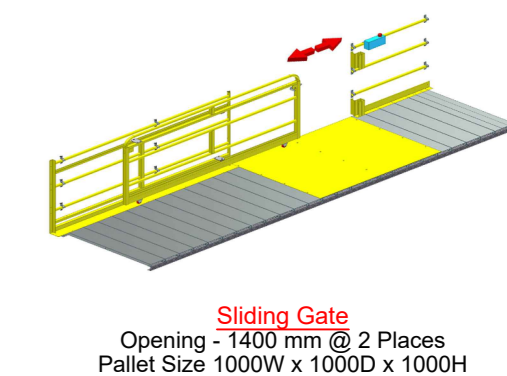

Sliding Gate  
Opening - 1400 mm @ 2 Places  
Pallet Size 1000W x 1000D x 1000H

DECKING DETAILS

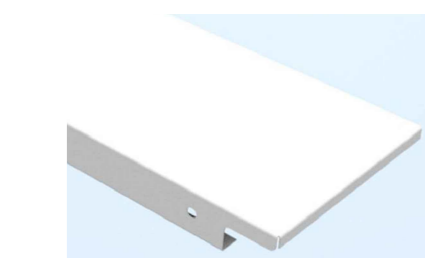

6Bend Decking  
For all Loading Levels

WALKWAY DETAILS

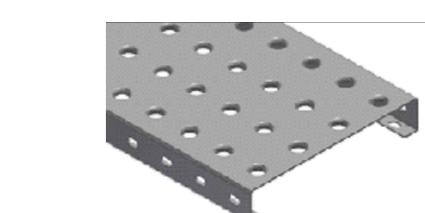

Perforated Steel Walkway Panel  
300 kg udl/sq. m  
Shown in Gray color

NOTES:

- Nil

DRAWING & PICTURE MAY NOT REPRESENT ACTUAL CONSTRUCTIONS



SHEET: A2 SCALE: 1:169

ALL DIMENSIONS ARE IN "mm"

SYSTEM HEAVY DUTY SHELVING

LOCATION HURL

LOCATION SINDRI

DRG.NO HURL.ST.00

CAPACITY DETAILS OF SHELVING

UNIT NAME	UNIT QTY	LEVELS/ UNIT	TOTAL LEVELS
A	136	11	1496
TOTAL CAPACITY			1496

DESIGN CONSIDERATIONS



Load on base plate  
4750 kg

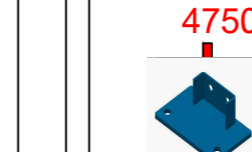

The floor Load capacity needs to be checked by customer  
160x110 mm Base Plate size